

OIL PUMP COMPONENTS

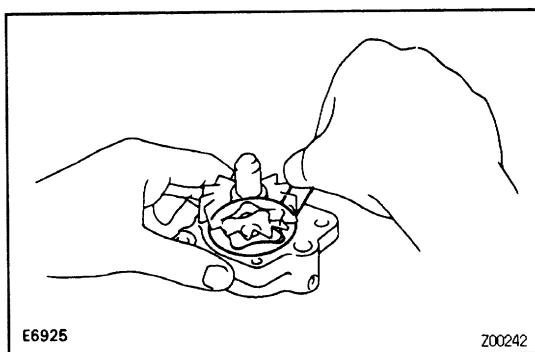
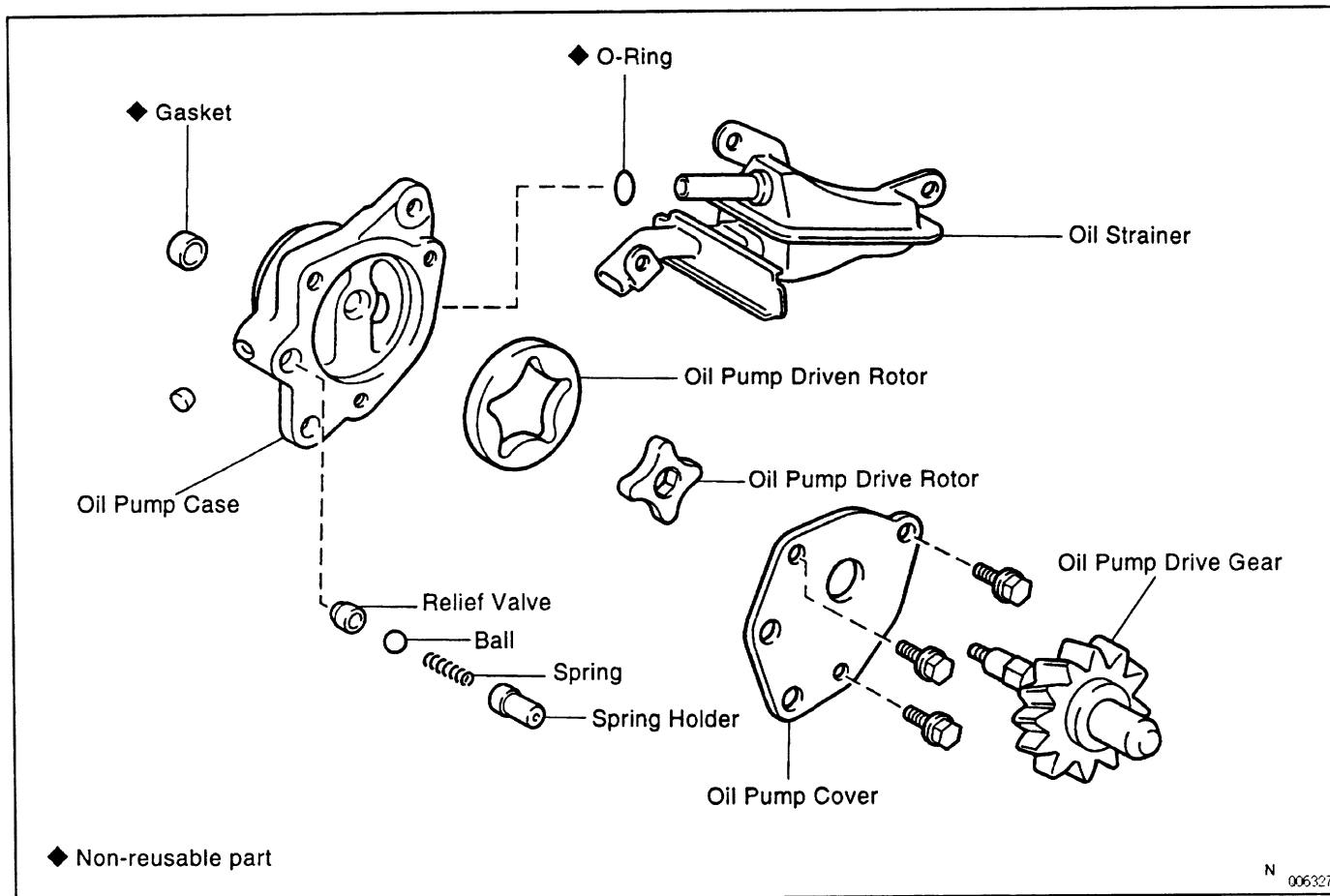

OIL PUMP INSPECTION

1. CHECK ROTOR BODY CLEARANCE

- Install the oil pump drive gear to the drive rotor.
- Using a feeler gauge, measure the body clearance between the drive rotor and oil pump case.

Standard clearance:

0.10 - 0.16 mm (0.0039 - 0.0063 in.)

Maximum clearance:

0.30 mm (0.0118 in.)

2. CHECK ROTOR TIP CLEARANCE

- Install the oil pump drive gear to the drive rotor.
- Using a feeler gauge, measure the tip clearance between the drive and driven rotors.

Standard clearance:

0.08 - 0.15 mm (0.0031 - 0.0059 in.)

Maximum clearance:

0.30 mm (0.0118 in.)

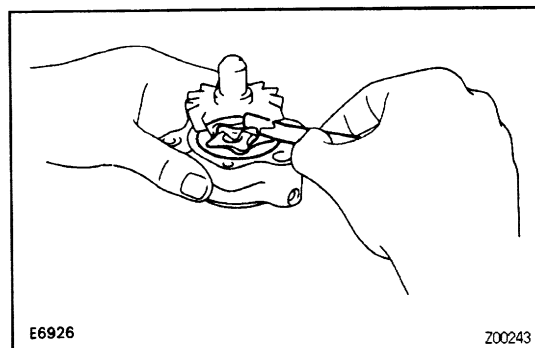

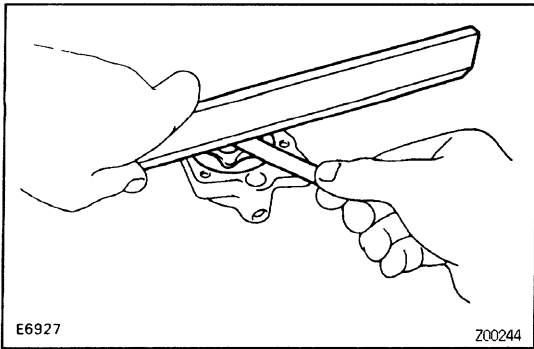

3. CHECK SIDE CLEARANCE

Using a precision straight edge and feeler gauge, measure the side clearance of both rotors.

Standard clearance:

0.03 – 0.08 mm (0.0012 – 0.0031 in.)

Maximum clearance:

0.15 mm (0.0059 in.)

SHIFT AND SELECT LEVER SHAFT COMPONENTS

